



2025

STEP PORTUGAL



Straw Bale Training for European Professionals

asbn

STEP : Training Center + ONLINE + Practical Courses

2025



Karsten Barth, DE

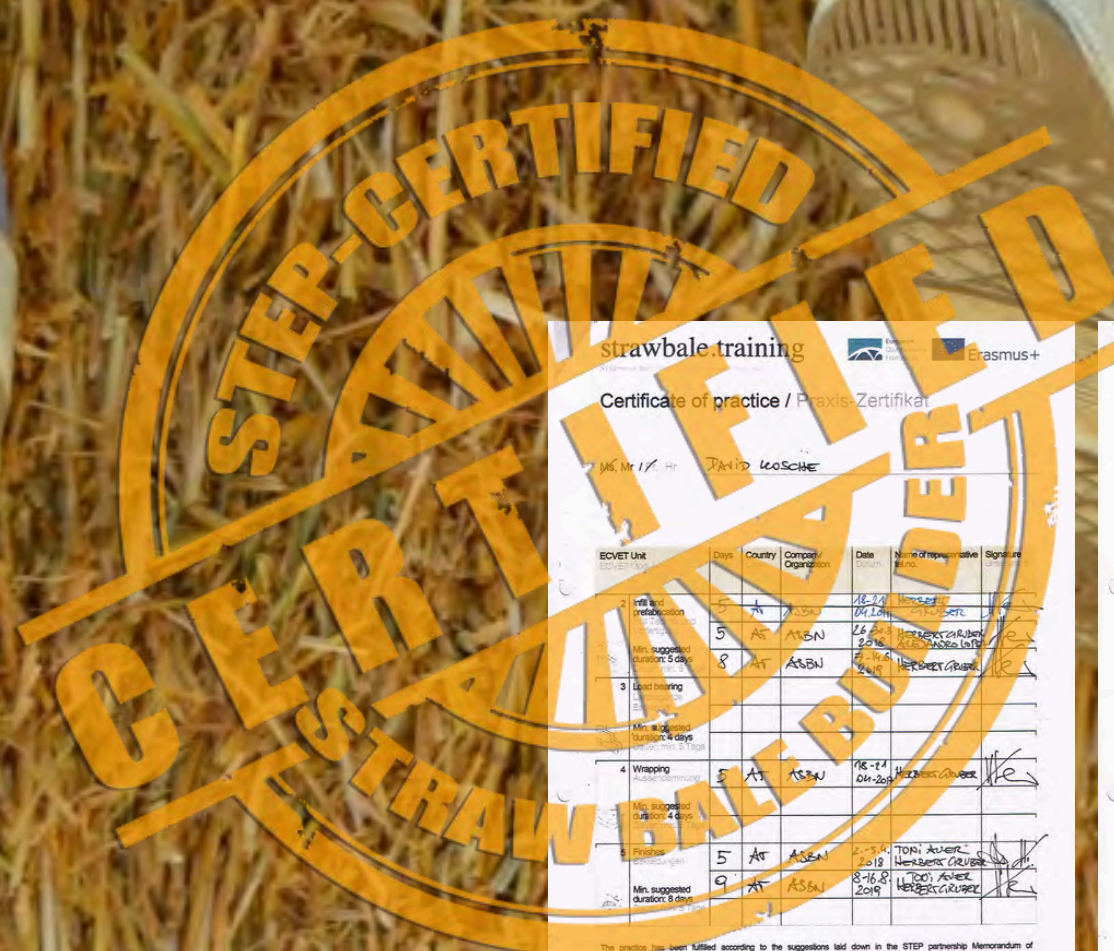

strawbale.training Erasmus+

Certificate of practice / Praxis-Zertifikat

MC No. 17 David KOSCHE

ECVET Unit	Date	Country	Company/Organization	Date	Name of representative	Signature
1. Infill and prefabrication	26.12.2019	AT	ASBN	26.12.2019	Herbert Gubel	[Signature]
2. Infill and prefabrication	26.12.2019	AT	ASBN	26.12.2019	Herbert Gubel	[Signature]
3. Load bearing	26.12.2019	AT	ASBN	26.12.2019	Herbert Gubel	[Signature]
4. Wrapping	26.12.2019	AT	ASBN	26.12.2019	Herbert Gubel	[Signature]
5. Finishes	26.12.2019	AT	ASBN	26.12.2019	Herbert Gubel	[Signature]
6. Building physics	26.12.2019	AT	ASBN	26.12.2019	Herbert Gubel	[Signature]
7. Concept of the house	26.12.2019	AT	ASBN	26.12.2019	Herbert Gubel	[Signature]
8. Marketing & communication	26.12.2019	AT	ASBN	26.12.2019	Herbert Gubel	[Signature]

The practice has been fulfilled according to the suggestions laid down in the STEP partnership Memorandum of Understanding. The ECVET Straw Bale Building units are defined in the STEP handbooks at www.strawbale.org

strawbale.training Erasmus+

Certificate of achievement / Leistungs-Zertifikat

Ms, Mr / Fr, Hr David Wilhelm KOSCHE

Date of birth / Geburtsdag 29.11.1971

Place of birth / Geburtsort Seibitzberg

LEVEL 2	ECVET Unit	Country	Organization	Date	Name of assessor	Signature
1	Introduction	AT	ASBN	26.12.2019	Herbert Gubel	[Signature]
2	Infill and prefabrication	AT	ASBN	26.12.2019	Herbert Gubel	[Signature]
3	Load bearing	AT	ASBN	26.12.2019	Herbert Gubel	[Signature]
4	Wrapping	AT	ASBN	26.12.2019	Herbert Gubel	[Signature]
5	Finishes	AT	ASBN	26.12.2019	Herbert Gubel	[Signature]
6	Building physics	AT	ASBN	26.12.2019	Herbert Gubel	[Signature]
7	Concept of the house	AT	ASBN	26.12.2019	Herbert Gubel	[Signature]
8	Marketing & communication	AT	ASBN	26.12.2019	Herbert Gubel	[Signature]

LEVEL 4	ECVET Unit	Country	Organization	Date	Name of assessor	Signature
1	Introduction	AT	ASBN	26.12.2019	Herbert Gubel	[Signature]
2	Infill and prefabrication	AT	ASBN	26.12.2019	Herbert Gubel	[Signature]
3	Load bearing	AT	ASBN	26.12.2019	Herbert Gubel	[Signature]
4	Wrapping	AT	ASBN	26.12.2019	Herbert Gubel	[Signature]
5	Finishes	AT	ASBN	26.12.2019	Herbert Gubel	[Signature]
6	Building physics	AT	ASBN	26.12.2019	Herbert Gubel	[Signature]
7	Concept of the house	AT	ASBN	26.12.2019	Herbert Gubel	[Signature]
8	Marketing & communication	AT	ASBN	26.12.2019	Herbert Gubel	[Signature]

The examination has been conducted according to the agreement laid down in the STEP partnership Memorandum of Understanding. The ECVET Straw Bale Building units are defined in the STEP handbooks at www.strawbale.org

Karsten Barth
geboren am 09.09.1967 in Aschersleben, DE

erhält hiermit das
Certificate of Achievement and Practice
„zertifizierter Strohballenbauer“
„certified straw bale builder“



asbn

STEP CERTIFIED

in Algarve, Portugal

register at baubiologie.at

STEP certified: in Algarve/Portugal + Practical Courses

2025

including all courses & workshops

€ 2.900,- / € 2.500,-* (or 10 rates)

half day practice in Portugal +
all other Workshops included as often as you want



Theory + Practice: Jan 8-11, 2025



Theory + Practice: Jan 13-17, 2025



Theory + Practice: Jan 20-24, 2025



Theory + Practice: Jan 27-31, 2025



Theory + Practice: Feb 3-7, 2025



Theory + Practice: Feb 17-21, 2025



Theory + Practice: Feb 24-28, 2025



Theory + Practice: March 3-6, 2025

* for Students and Unemployed

mit 1 Woche
Urlaubs-Pause



Final Assessment: March 11/12

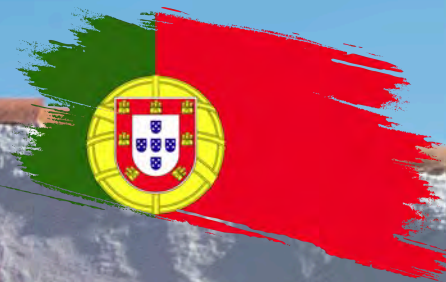

QUINTA DE FORNALHA

3 Star Accommodation
2 Bed-Appartments
with Terrace, Kitchen,
Heating and Bathroom
Organic Fruit and Vegetables





CASTRO MARIM, ALGARVE



CASTRO MARIM, ALGARVE

5m to Terrace (Walk)

100m to Train Station (Walk)

3,1km to the Beach (Bicycle)

60km to Airport Faro (Train)

88km to Albufeira (Train)

4 h 32 min from Lisbon (Train)

asbn

STEP - the Modules

STEP - die Module

register at baubiologie.at

STEP U1: Intro into Straw / Straw Bale Building

theory & practice



STEP U2: Infill & Prefab

theory & practice



THEORY
Straw Bale Infill Construction Systems
Construction Plans
Structural Engineering & Building Details
Hybrid Constructions (CUT, GREB,...)
Prefab, Modules, Roofs, Base Plates
Building Law & Regulations

PRACTICE
Construction of a small project
Infill, Roof, Base Plate & Foundation



STEP U3: Load bearing Straw Bale Building

theory & practice



THEORY
History, Myths & Statics of load bearing Construction
Building with small and big bales
Architecture, Design & Restrictions of load bearing Buildings



PRACTICE
Sample load bearing Wall & Vault
Compression, Corners, Top Plates



STEP U4: Wrapping (thermal straw insulation)

theory & practice



THEORY
Check list and Wrapping Plan
Wrapping with full Bales incl. Prefab
Wrapping with Straw Flakes
Wrapping with Straw Boards & Mats
Inside Insulation & Refurbishment
U-Value & Humidity Calculation

PRACTICE
Sample Wrapping Wall, different systems
windproof Finishing options

STEP U5: Natural Finishes (Clay/Lime), Cladding

theory & practice

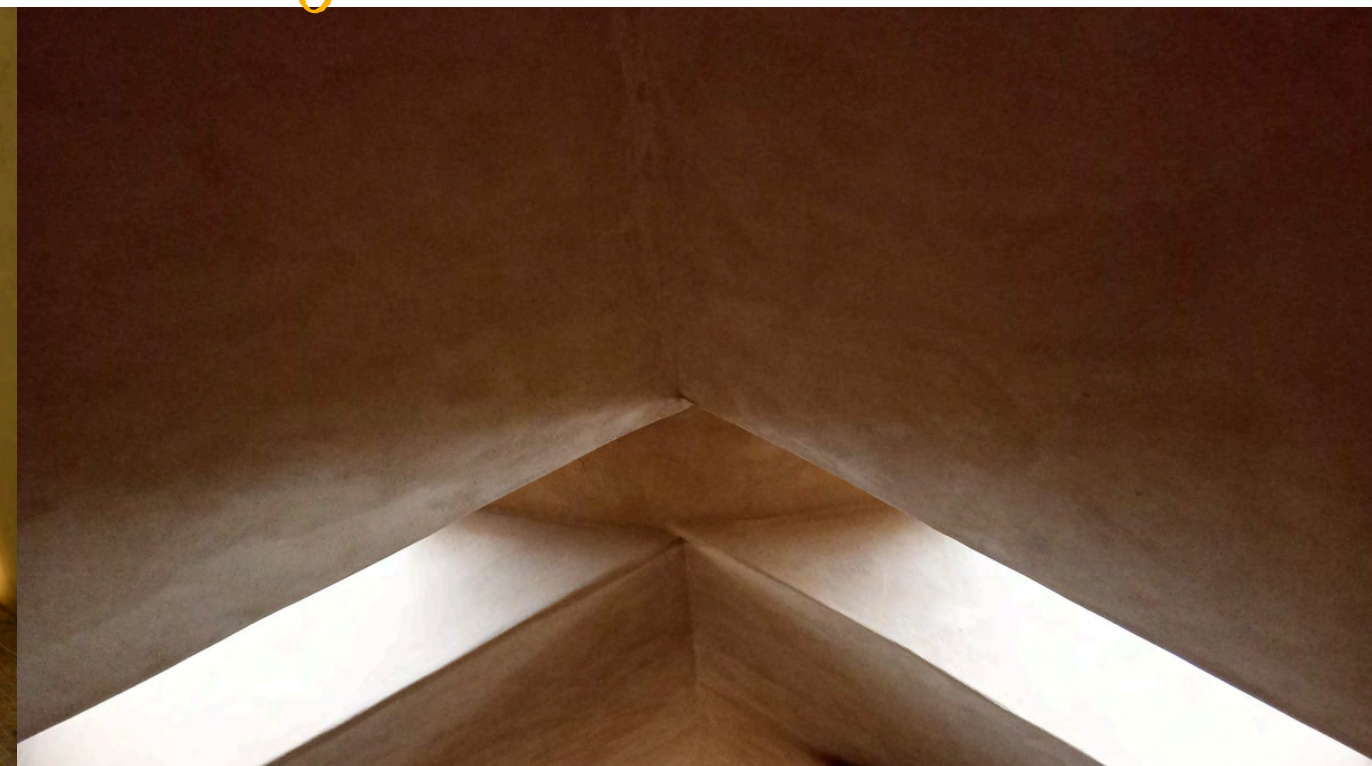

THEORY
Functions of a plaster/render
Earth building techniques & solutions
Earth plaster & analysis/tests
Plaster preparation and mixture
Lime render step-by-step
Decoration with clay plasters
Cladding (esp. wooden cladding)



PRACTICE
Earth/Clay, Lime & Tadelakt
Analysis, Finishing Techniques



STEP U6: Building Physics (to avoid mistakes)^{theory}



STEP - STRAW BALE BUILDING TRAINING FOR EUROPEAN PROFESSIONALS



STEP - STRAW BALE BUILDING TRAINING FOR EUROPEAN PROFESSIONALS



STEP - STRAW BALE BUILDING TRAINING FOR EUROPEAN PROFESSIONALS

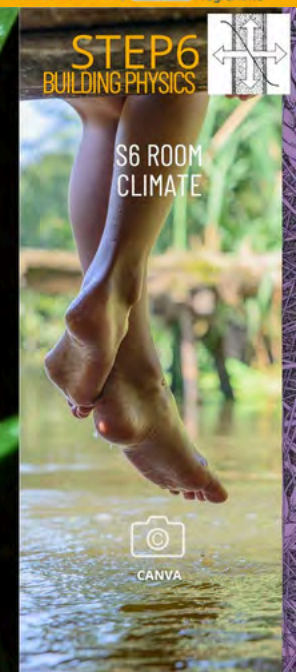
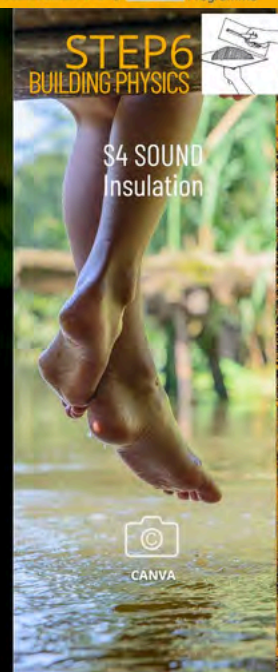

STEP - STRAW BALE BUILDING TRAINING FOR EUROPEAN PROFESSIONALS



STEP - STRAW BALE BUILDING TRAINING FOR EUROPEAN PROFESSIONALS



STEP - STRAW BALE BUILDING TRAINING FOR EUROPEAN PROFESSIONALS



STEP U7: Straw House (Construction) Design *theory*

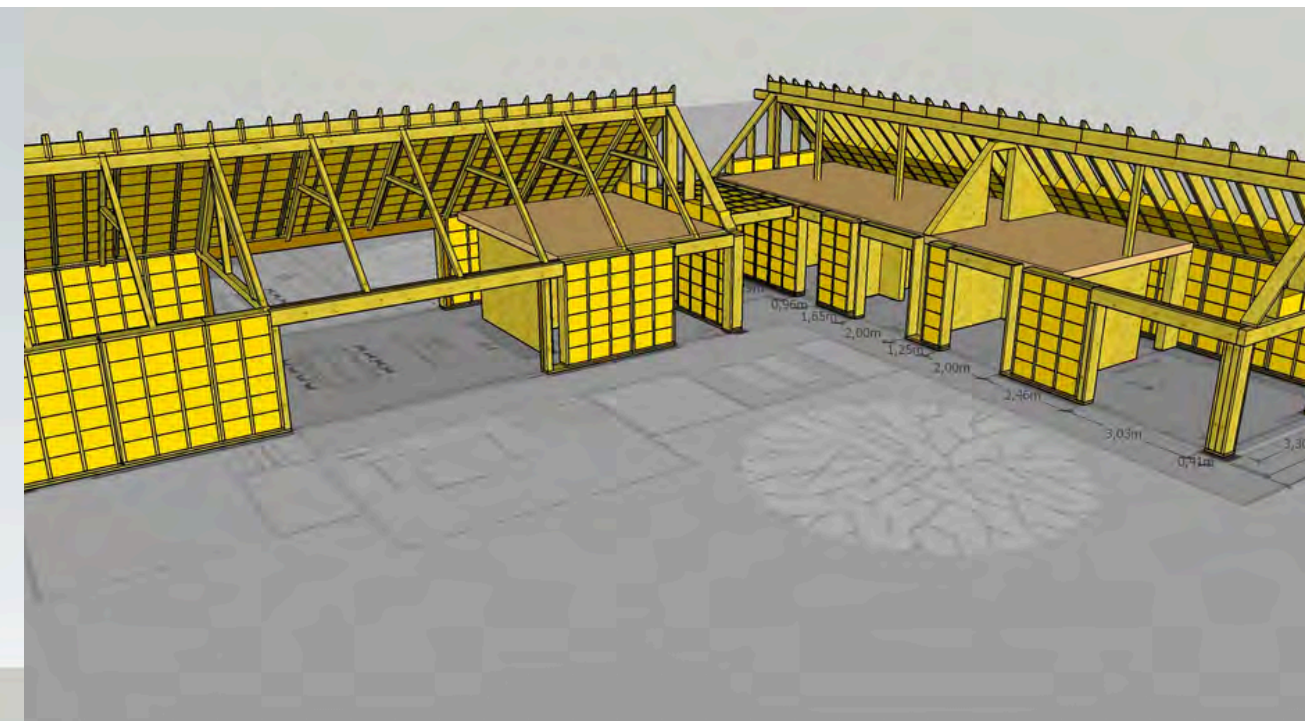
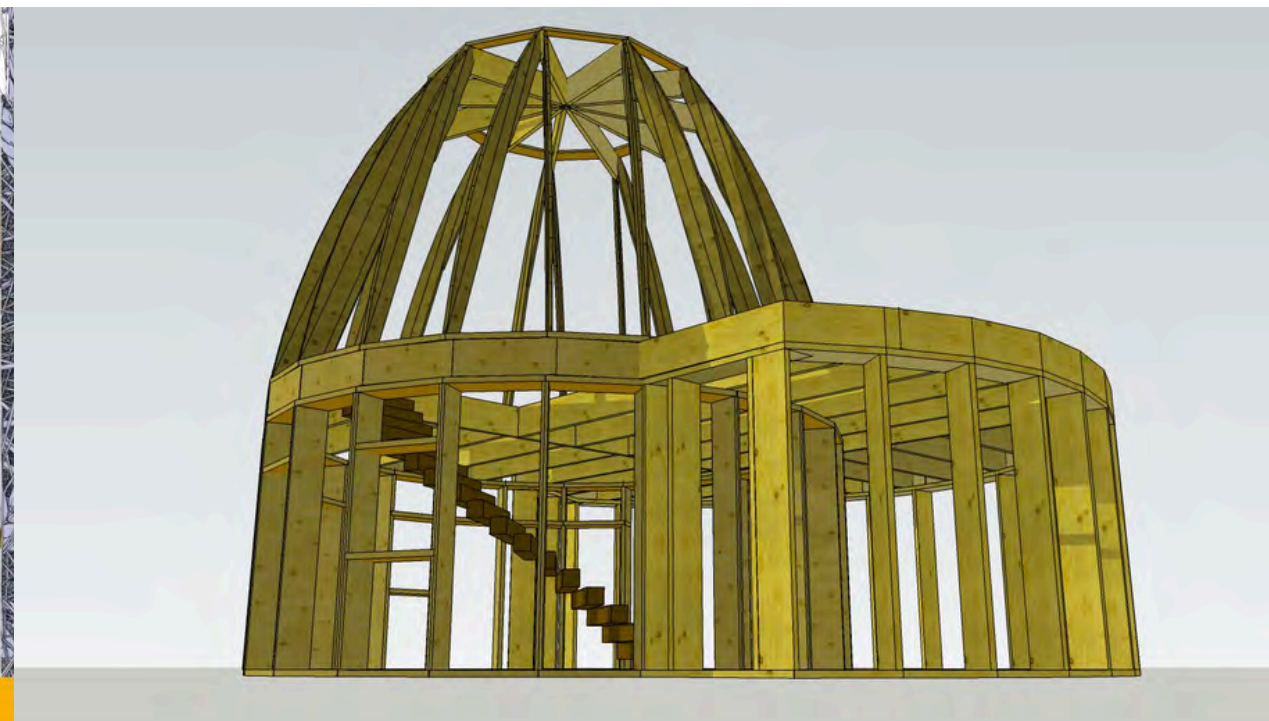

STEP U8: Communication & Calculation

theory



asbn

U8 Communication

STEP Straw Building Training for European Professionals

STEP U8
Communication and Calculation

ecvvet European Credit system for Vocational Education & Training

Lifelong Learning Programme

CANVA

asbn

U8 Communication

S1 TALKING to Clients

TALKING to Clients

ecvvet European Credit system for Vocational Education & Training

Lifelong Learning Programme

CANVA

asbn

U8 Communication

S2 ESTIMATION of Building Costs

ESTIMATION of building costs

ecvvet European Credit system for Vocational Education & Training

Lifelong Learning Programme

CANVA

asbn

U8 Communication

S3 CALCULATION of Building Costs

CALCULATION of building costs

ecvvet European Credit system for Vocational Education & Training

Lifelong Learning Programme

CANVA

asbn

U8 Communication

S7 FEEDBACK

Daily Feedback

COMMENT

FEEDBACK

REVIEW

OPINION

ecvvet European Credit system for Vocational Education & Training

Lifelong Learning Programme

CANVA

asbn

U8 Communication

S4 IMAGE & TEXT

IMAGE & TEXT
print or presentation

ecvvet European Credit system for Vocational Education & Training

Lifelong Learning Programme

CANVA

asbn

STEP - the Online

Learning Platform

register at baubiologie.at

STEP Online Learning Platform acteco.eu

also free courses



STRAW BUILDING
for Teachers
(Level 2)

Methodology - Activities - Sources - Teaching Plan

EARTH BUILDING
for Teachers
(Level 2)

Methodology - Activities - Sources - Teaching Plan

EARTH BUILDING
for Teachers
(Level 2)

Methodology - Activities - Sources - Teaching Plan

SUSTAINABILITY
for Teachers
(Level 2)

Methodology - Activities - Sources - Teaching Plan

SUSTAINABILITY
for Teachers
(Level 2)

Methodology - Activities - Sources - Teaching Plan

Straw Building Short Courses on acteco.eu

free courses

ActECO

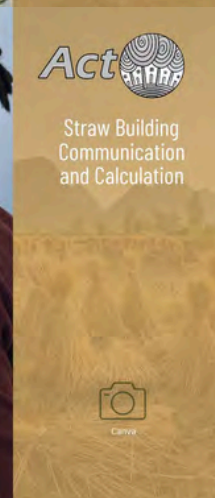
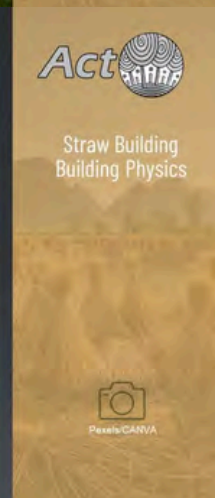
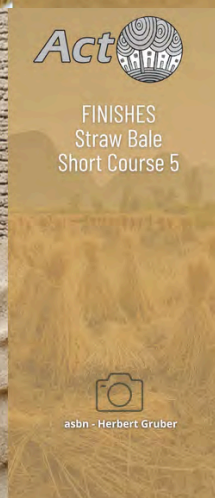
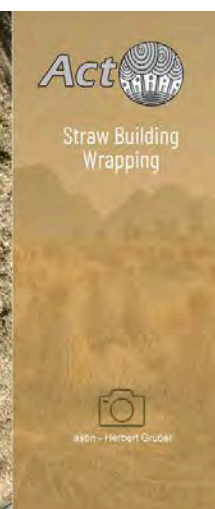
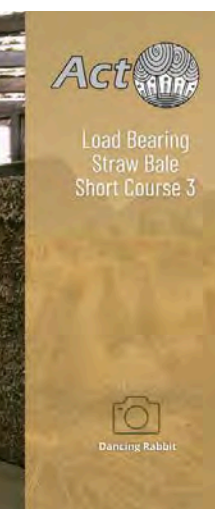
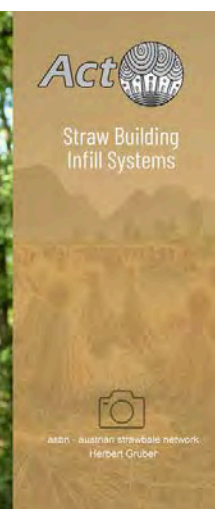

asbn

STEP Practice: 25 days

STEP Praxis: 25 Tage

Info & registration at strohnatur.at